

TME ACTIVECORE™

Glass Door Chiller

Display / Storage Top Mount - Limited options

A new glass door chiller combining SKOPE's revolutionary new ActiveCore technology with a modern frameless aesthetic design. These models provide market leading energy savings along with new features to deliver optimal performance, efficiency and reliability.

Options

Available in 1, 2 and 3 door models
Additional shelves
Illuminated sign panel

Revolutionary removable ActiveCore refrigeration system

Fitted with lock tabs for extra security

Significantly reduced noise and improved quality, for a quieter operation

A frameless glass door design with aluminium trim

A patented easy to install shelf clip and numbered shelf support strip, significantly reduces shelf set up time and enables finer adjustments

SIGNIFICANT ENERGY SAVINGS

Uses 55% less energy than the previous TME1000-H model, saving \$616 per year**

Sign panel options for branding opportunities

Updated controller with manual light switch and pre-programmed features

Premium energy efficient glass using new low-emissivity coating technology, equivalent to double Low-E performance. An invisible finish ensures maximum visual clarity**

New slotted back panel design allows chilled airflow to be pushed directly on the product

Ergonomically designed, brushed stainless steel door handles

Optimal airflow and cooling performance reduces temperature variations and energy consumption



Available in white only



Easy to remove ActiveCore Cartridge System inside



Warranty
2 year protection



High Energy Efficiency



ActiveCore™

Specifications

TME ActiveCore™ Display / Storage Top Mount

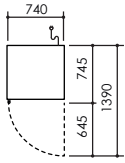

Integral top view

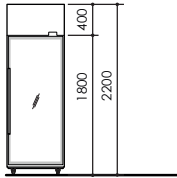

Integral front elevation

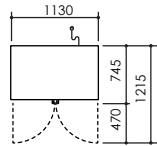

Integral top view

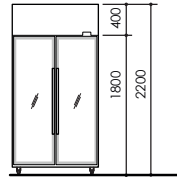

Integral front elevation

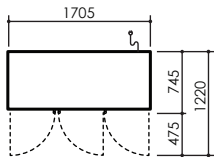

Integral top view

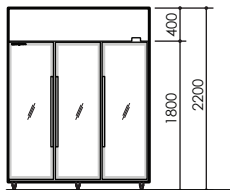

Integral front elevation

TME650-A - GLASS DOOR

Model	Integral/Remote	Chiller/Freezer	Colour	
TME650-A	Integral	Chiller	White	
	External (mm)	Internal (mm)		
Height***	2200	1570		
Width	740	640		
Depth****	745	554		
<ul style="list-style-type: none"> • 4.23 MEPS (kWh/24hr/m²) • Minimum 300mm clear ventilation space required above cabinet top • +1°C to +4°C in 43°C ambient • 3.1 TEC (kWh/24h) 				Gross Volume 610 litres Total Shelf Area 1.76m ² (inc. floor) Floor Area 0.55m ² Weight 170 kg
				TME650-A 1 DOOR

TME1000-A - GLASS DOORS

Model	Integral/Remote	Chiller/Freezer	Colour	
TME1000-A	Integral	Chiller	White	
	External (mm)	Internal (mm)		
Height***	2200	1570		
Width	1130	1030		
Depth****	745	554		
<ul style="list-style-type: none"> • 4.41 MEPS (kWh/24hr/m²) • Minimum 300mm clear ventilation space required above cabinet top • +1°C to +4°C in 43°C ambient • 4.65 TEC (kWh/24h) 				Gross Volume 980 litres Total Shelf Area 2.86m ² (inc. floor) Floor Area 0.84m ² Weight 225 kg
				TME1000-A 2 DOOR

TME1500-A - GLASS DOORS

Model	Integral/Remote	Chiller/Freezer	Colour	
TME1500-A	Integral	Chiller	White	
	External (mm)	Internal (mm)		
Height***	2200	1570		
Width	1705	1605		
Depth****	745	554		
<ul style="list-style-type: none"> • TBA MEPS (kWh/24hr/m²) • Minimum 300mm clear ventilation space required above cabinet top • +1°C to +4°C in 43°C ambient • TBA TEC (kWh/24h) 				Gross Volume 1497 litres Total Shelf Area 3.65m ² (inc. floor) Floor Area 1.27m ² Weight 320 kg
				TME1500-A 3 DOOR

*Based on 30 cents per kW. Calculated using 4.65 kWh/24h(TEC) with sign replacement panel

**For tropical installations please speak to a SKOPE representative

***Height includes castors

****Total depth includes removable 50mm handles : excludes 50mm retractable stand-off